

PRVA AUDIO

Scan QR Code to download the App

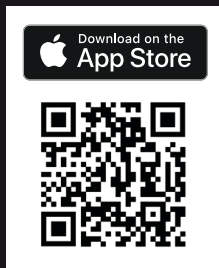
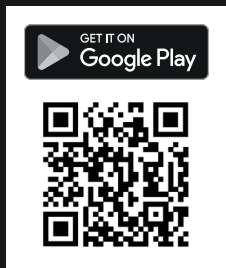

DSP 2.4X BT

Bluetooth Digital Signal Processor

USER'S GUIDE

Introduction

Thank you for choosing **PRV Audio Brazil**!

The **DSP 2.4X BT** was designed to enhance your audio experience by modernizing the well-known **DSP 2.4X**.

Now featuring Bluetooth technology and a dedicated app for Android and iOS, it offers full control of the processor directly from your smartphone — no need for physical access to the device.

The new DSP brings advanced professional features, allowing precise, customized fine-tuning, making it ideal for any sound system project, whether automotive or home audio.

It also includes three dedicated outputs for the sequencer feature, which enables multiple devices to be powered on or off in sequence. This function can be configured either on the processor itself or via the app.

Features

The processor includes **2 input channels (A and B)** and **4 independent output channels (1, 2, 3, and 4)**, as follows:

INPUTS	MAIN IN: Connection RCA (A e B)
	HIGH-IN: Connection FIO (A e B)
OUTPUTS	OUT 1: RCA (L + R)
	OUT 2: RCA (L + R)
	OUT 3: RCA (L + R)
	OUT 4: RCA (L + R)

INPUT CONNECTIONS



HIGH CONNECTION (WIRE)
Common in factory head units and original vehicle audio systems.



RCA INPUT (LINE)
Common in aftermarket head units and audio equipment.

The digital signal processing features allow precise audio adjustments through a variety of integrated functions and tools:

- **AUDIO ADJUSTMENTS DIRECTLY ON THE PROCESSOR OR THROUGH THE MOBILE APP;**
- **RCA & HIGH-LEVEL (WIRE) AUDIO INPUTS;**
- **GRAPHIC EQUALIZER;**
- **PARAMETRIC EQUALIZERS** for both input and output;
- Flexible input-to-output **ROUTING;**
- High-precision **CROSSOVER** (with Butterworth, Linkwitz-Riley, and Bessel filters);
- High-precision **DELAY;**
- **PHASE INVERSION;**
- **LIMITER** with adjustable Threshold, Attack, and Release;
- **MASTER VOLUME, GAIN, and MUTE** control for each output;
- **CHANNEL LINK** for simultaneous parameter adjustments across linked channels;
- **AUTOMATIC SAVE** and **LOAD** for storing and retrieving audio settings;
- **SECURITY PASSWORD** to prevent unauthorized parameter changes;
- **FREQUENCY GENERATOR** and sweep function;
- Integrated **SEQUENCER** for remote triggering with configurable timing.

Before Installing

Please read this manual carefully before using the product.

- All product connections must be made with the unit turned **OFF**.
- Installing a fuse between the product and the battery is mandatory for protection against overload. The fuse must match the product's current draw and be installed as close to the battery as possible.
- Use the wire gauges recommended in this manual to prevent cable overheating and ensure maximum performance.
- Keep the cables as short as possible to increase sound fidelity and avoid potential power loss.
- Route the installation cables as far as possible from the vehicle's original wiring to minimize interference and noise in your audio system.
- Connect the Bluetooth antenna to the designated connector on the processor, making sure it is firmly attached for optimal signal reception.
- For best performance, install the processor in a location with minimal metal obstructions to avoid signal dampening inside the vehicle.
- Install in a secure, well-ventilated, and dry area.
- Installation should be performed by a qualified professional.

Processor Overview

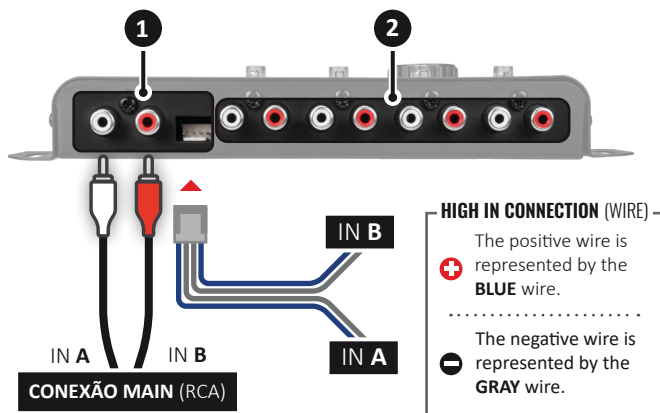

1. INPUT: The processor features two types of input connections: **RCA** and **HIGH (WIRE Input)**. Both share the same input channels (**A and B**), so you can use them according to your needs..



Using both RCA and HIGH INPUT connections at the same time may cause unwanted noise.

2. OUTPUT: Features **4 independent RCA outputs (L+R)** for connecting amplifiers and other audio equipment. These outputs are processed according to the audio parameters set by the user.

3. LCD DISPLAY: Allows for viewing and interacting with the processor's system.

4. INPUT CLIP INDICATOR: Indicates that the incoming audio level is too high, which may cause distortion. Adjust the source volume to prevent damage and ensure better sound quality.

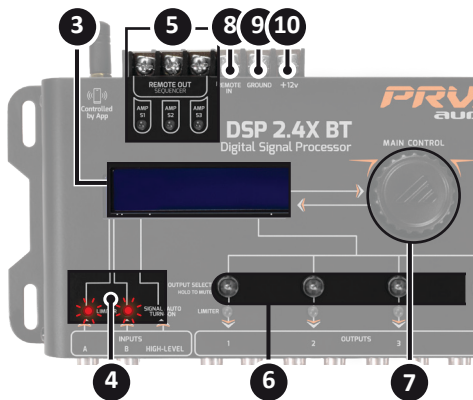

5. REMOTE OUT (SEQUENCER): The processor features three dedicated outputs for the sequencer function, allowing multiple devices to be powered on or off in sequence. These connections can be configured directly on the processor or via the mobile app. Use cables with a minimum gauge of **18 AWG** to ensure a safe and efficient connection.

6. HOTKEY BUTTONS: Dedicated buttons for selecting the channel to apply parameters or for activating the **MUTE** function.

PRESS AND RELEASE:

Press to quickly select the channel where audio parameters will be applied.

PRESS AND HOLD:

Hold to **ENABLE** or **DISABLE** the channel's **MUTE** mode.



BLUE LED

Indicates the output channel is active.



RED LED

Indicates the output channel is muted (OFF).

7. MAIN CONTROL: Used to navigate through the system features and adjust parameters.

OPERATING MODES:

PRESS AND RELEASE:

Used to enter functions, make selections, and skip to the next parameter.

PRESS AND HOLD:

Returns to the previous screen or main menu.

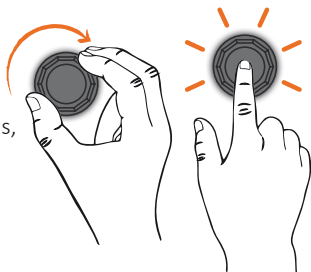

8. REMOTE TURN-ON CONNECTOR (REM): Activates the processor when this connection is powered. Connect the remote output from the head unit/player using an **18 AWG** wire, or use a manual on/off switch connected to a **12V** power source.

9. POSITIVE CONNECTOR  : Connect to the positive terminal of the battery or a 12V power supply using a cable with a minimum gauge of **13 AWG**. If using the vehicle's battery, install a **1A** fuse for electrical protection no more than **12 inches** from the battery.

10. NEGATIVE/GROUND CONNECTOR  : Connect to the negative terminal of the battery or power supply using a **13 AWG** wire.

USING THE PROCESSOR DIRECTLY WITH A 12V POWER SUPPLY.

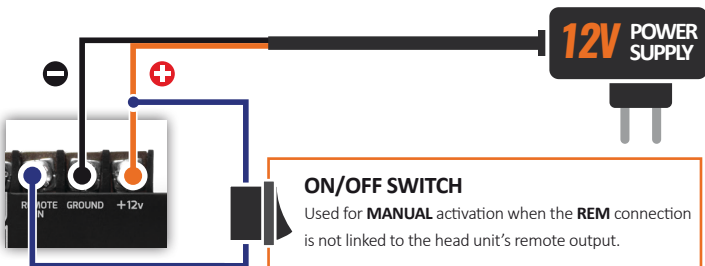

12V Battery Power Supply Diagram

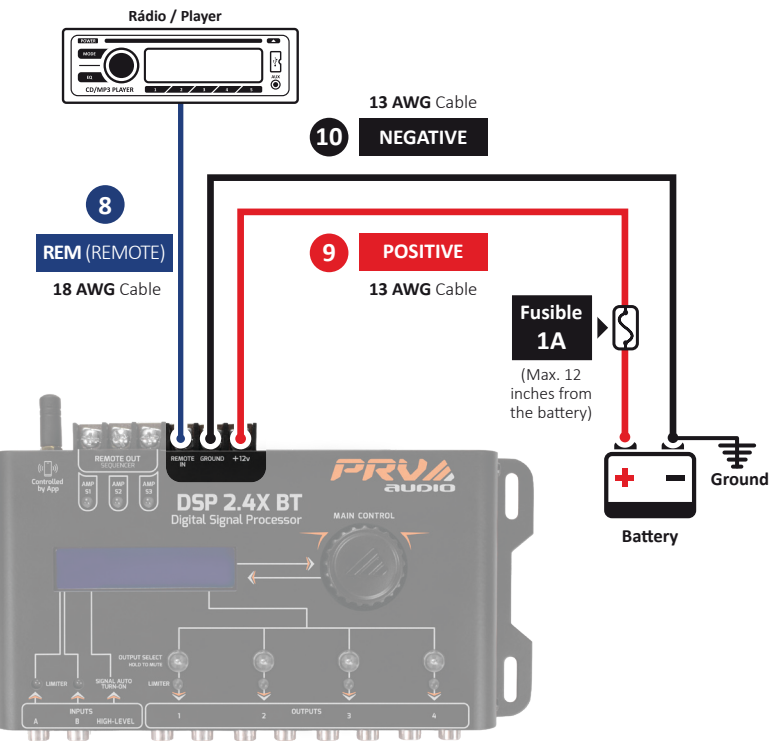

INSTALLATION MUST BE PERFORMED ONLY BY QUALIFIED PROFESSIONALS AND WITH THE UNIT TURNED **OFF**. A FUSE IS MANDATORY TO PROTECT THE SYSTEM FROM SHORT CIRCUITS AND OVERLOADS.
INSTALL IT AS CLOSE TO THE BATTERY AS POSSIBLE.

App Installation

Before connecting the DSP 2.4X BT to your smartphone, make sure it meets the minimum requirements to properly install and operate the app.

MINIMUM REQUIREMENTS

- Devices running Android 8.0 or higher
- Devices running iOS 15 or higher



Install the App on Your Device

Download and install the app to explore all its features. In the app store, search for **"PRV DSP"** or use the shortcuts below to access it directly.



Click on the store that matches your device to be redirected, or scan the **QR code**.



Pairing the Product with the App

With the app installed and the product powered on, open the app on your smartphone to begin the pairing process.



You must **ALLOW** all permissions requested by the app to ensure it functions properly.

On the app's pairing screen, wait for the **DSP 2.4X BT** to appear in the list of available devices.

DEMO MODE: Allows you to explore all the app's features without needing to connect to the processor, operating with limited functionality and simulated data.

CONNECT: Searches for devices via Bluetooth to initiate pairing.

INFO: Displays product information, including the user manual and software version, available whether or not the processor is connected to the app.

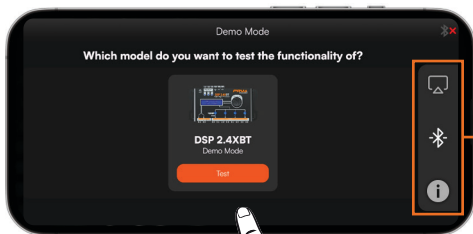

Next, tap the **CONNECT** button below the name and image of your product.

**IF PROMPTED,
ENTER THE DEFAULT
PASSWORD: 1234.**

The connection process will start automatically and should take only a few seconds to complete.



IN SETTINGS, YOU CAN ENABLE OR DISABLE THE AUTOMATIC CONNECTION MODE. TO ENSURE YOUR SECURITY, CHANGE THE DEFAULT PASSWORD IN THE SETTINGS MENU.

PRV DSP App Overview

Discover some of the features and tools available in the app. With an intuitive interface and simple navigation, it allows you to configure and control your audio system quickly and easily.

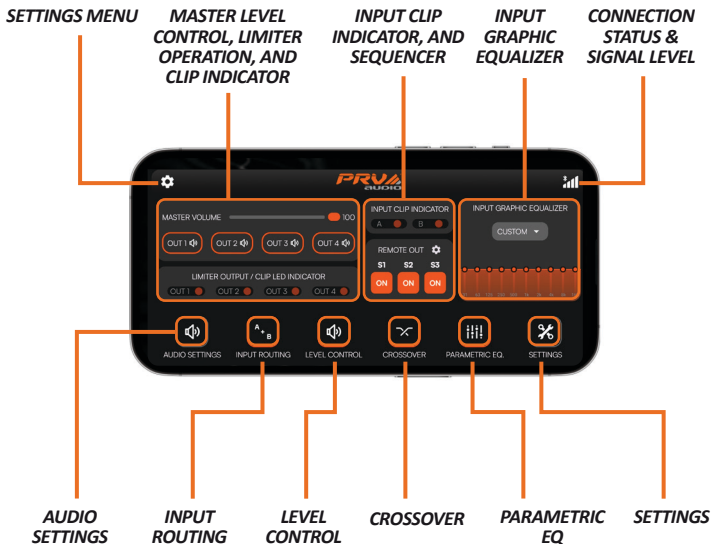

Processor Flowchart

The illustration below shows the complete audio path within the system - from the input stage to the final adjustments at the outputs.

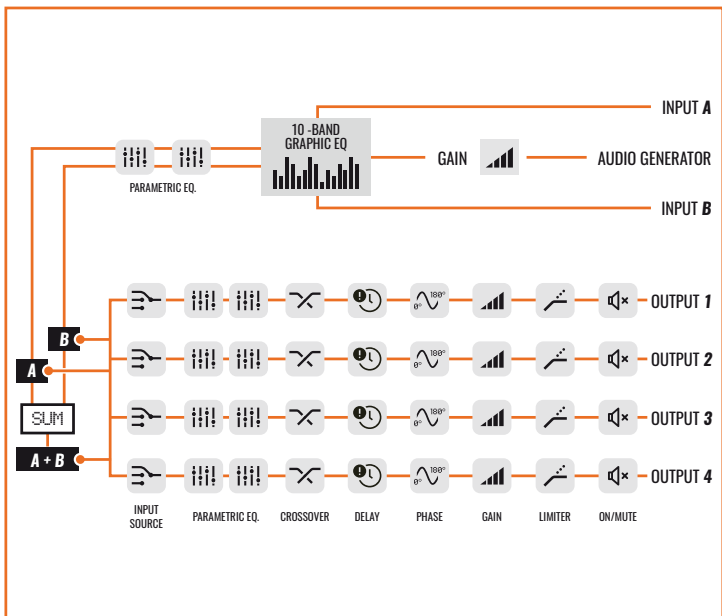

> INPUT GRAPHIC EQUALIZER

The input graphic equalizer features 10 bands with frequencies equally spaced at 2/3 octave intervals, ranging from 31Hz to 16kHz. It allows gain adjustment of ± 12 dB in 0.1dB steps.

Graphic EQ
f: 63 Hz +2.6 dB

The graphic equalizer affects both input channels simultaneously.

> GRAPHIC EQ PRESETS

The processor offers 12 preset graphic EQ settings plus one customizable option, labeled **Custom**. These can be selected directly on the processor or through the app via the **Graphic Equalizer** option in the audio menu.

AUDIO INPUTS
Graph EQ Presets

GRAPH EQ PRESETS
FLAT

LIST OF PRESETS AVAILABLE ON THE PROCESSOR OR VIA THE APP:

- FLAT • LOUDNESS • BASSBOOST • MID BASS • TREBLE BOOST • POWERFUL
- ELECTRONIC • ROCK • HIP HOP • VOCAL • POP • PANCADAO

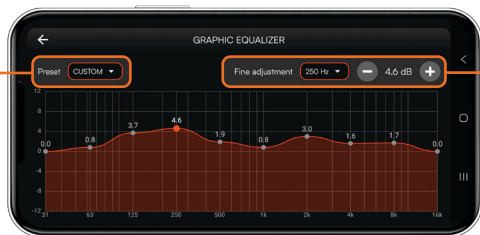

FINE ADJUSTMENT: Dedicated controls for selecting the frequency and precisely adjusting the gain.

> INPUT AND OUTPUT PARAMETRIC EQUALIZERS

Choose to boost or attenuate a specific frequency, and set the bandwidth of the equalization using the “Q” factor. The lower the “Q,” the wider the bandwidth, affecting a broader range of neighboring frequencies.

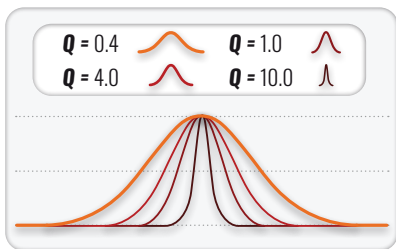

f: 214 Hz P1 IN
e: +3.2dB Q: 1.3

> INPUT ROUTING

Defines the signal source for each system output, with the following options: **A, B, or A+B (sum of signals A and B).**

On the processor, selection is done by rotating the **MAIN CONTROL** on the desired output. To switch between output channels, use the **HOTKEY** shortcut button.

ROUTING
IN A+B ---> OUT1

In the app, the configuration is displayed separately for each output channel, with A, B, and A+B buttons, allowing quick and visual selection of the desired audio source.

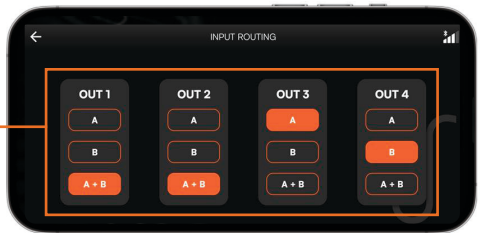

> CROSSOVER

The Crossover feature applies frequency filtering to the audio signals, directing each frequency band to its corresponding system output.

On the processor, rotate the **MAIN CONTROL** to adjust the selected parameter, such as filter type, cutoff frequency, slope, or topology, and use the **HOTKEY** to switch between output channels during adjustment.

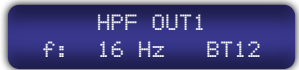

AVAILABLE FILTERS AND SLOPES:

Butterworth: 12/18/24/30/36/42/48 dB/8^a

Linkwitz-Riley: 12/18/24/30/36/42/48 dB/8^a

Bessel: 12/18/24/30/36/42/48 dB/8^a



The app configuration allows you to set the cutoff frequencies for both **H.P.F** and **L.P.F**, as well as select the slope and topology for each filter.

> ALIGNMENT / DELAY

Digitally correct the arrival time of each frequency band at the listener's position, improving sound fidelity and preventing frequency cancellations.

On the processor or in the app, you can adjust delay values per channel, with display options in either centimeters or milliseconds.

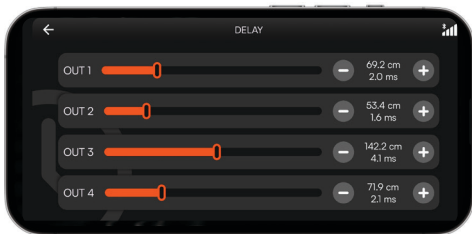
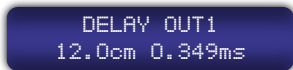

THE ADJUSTMENT CAN BE MADE AS FOLLOWS:

1. Identify the voice coil that is farthest from the front panel of the speaker enclosure and use it as a reference point.
2. Measure the distance of the other voice coils relative to the reference. Enter these distances into the delay settings for each channel.

MEASUREMENT EXAMPLE:

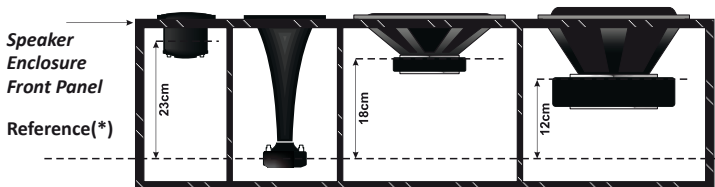

> PHASE

This function helps resolve frequency cancellation issues.

On the processor, rotate the **MAIN CONTROL** to switch the phase of the selected output between 0° and 180°.

PHASE
OUT1: 180



In the app, simply select the channel you want to adjust to change the phase.

> LIMITER

Works like a compressor, reducing the signal level based on the RMS value. This function is essential for protecting amplifiers and speakers, ensuring the audio does not exceed safe levels for continuous operation.

On both the processor and the app, the limiter parameters are:

THRESHOLD: Sets the signal level limit.

When this value is exceeded, the limiter is automatically activated.

LIM. OUT1 ON
THRES.: 0.0 dB

ATTACK: Controls how quickly the limiter responds after the signal surpasses the threshold.

LIM. OUT1 ON
ATTACK: 0.1 ms

RELEASE: Determines how long the limiter takes to return the signal to its normal level after gain reduction is no longer needed.

LIM. OUT1 ON
RELEASE: 500 ms

> LIMITER

Limiter behavior adjustment screen: allows you to configure the **THRESHOLD**, **ATTACK**, and **RELEASE** parameters, which determine how the signal is controlled when reaching peak levels.

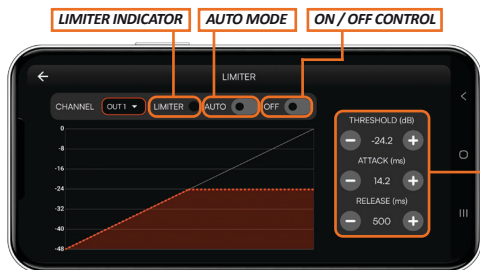

In addition to manual **Attack** and **Release** adjustments, you can enable **AUTO** mode, where these parameters are dynamically controlled in real time by the **Automatic Dynamic Limiter** system, ensuring greater sound fidelity and effective protection for your equipment.

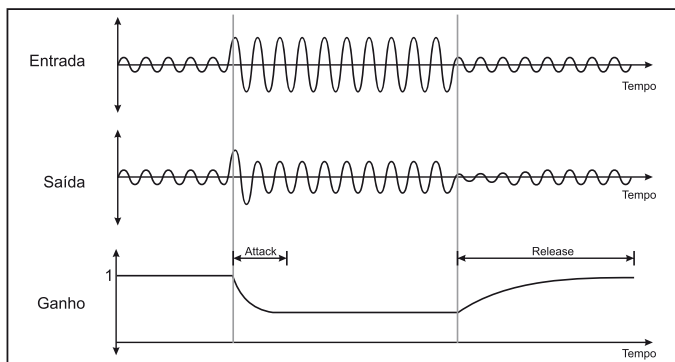

LIMITER INDICATOR LEDs:

The LEDs indicate when the Limiter function is active on the corresponding channel. Even when the limiter is not enabled, the LEDs still function as signal saturation indicators.

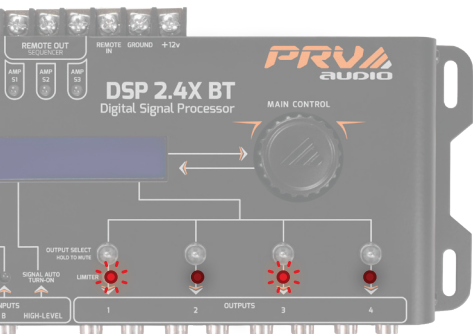

LEDs On:

Limiter active



LEDs Off:

Signal within normal parameters

> LEVEL CONTROL / OUTPUT GAIN

Allows individual gain adjustment for each output from -45 dB to ± 15 dB, with 0.1 dB precision.

MASTER LVL: 55%
OUT1: +0.5 dB

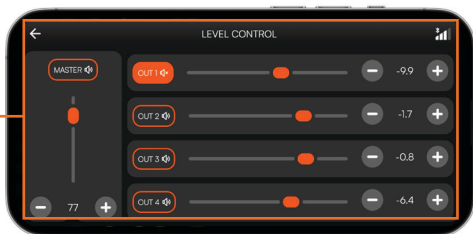

The **MASTER LEVEL** controls the overall volume from 0 to 100%, either through the app or directly on the processor. On the same screen, you can access individual channel adjustments and the **MUTE** function.

> MUTE

Outputs can be quickly enabled or disabled using the corresponding **HOTKEY** shortcut. Additionally, on the

MUTE screen, you can manually control the channels, turning each output on or off individually, or all at once. In the app, the **MUTE** button is located in the Master Level section interface, allowing you to control the outputs directly from your smartphone.



```
OUT3: OFF
MAIN(ALL): ON
```

MAIN MENU ▶ SAVE / LOAD

> SAVE / LOAD ON THE PROCESSOR

You can store up to 3 profiles in the processor's internal memory, which can be loaded at any time with all previously adjusted parameters. Each profile can have a custom name.

The processor also features automatic saving: all parameter and setting changes are recorded immediately. This ensures that no configuration is lost, even if the product is powered off during adjustments.

To load previously saved parameters, use the **LOAD** menu. To return to the original settings, you can restore the factory parameters through the **DEFAULT** memory.



```
SAVE MEMORY1
Memory1
```



```
LOAD
Default
```



```
CONFIRM LOAD?
NO [YES]
```

In the app, you can manage configuration profiles. Icons for **SAVE**, **LOAD**, and **EDIT** are available, allowing you to customize profile names.

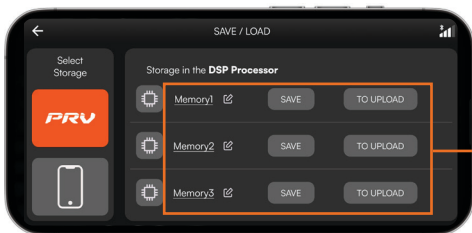

> SAVE / LOAD ON THE SMARTPHONE

The app allows you to save settings directly to your smartphone's memory, making it easy to store and organize different profiles. Files can be shared with other users via messaging apps, email, or cloud storage platforms. When tapped, the system automatically recognizes them and offers the option to open them in the app, streamlining the loading process to the processor.

The **IMPORT** function allows you to load previously saved **PRV** settings. To use it, open the "Import" icon in the app and locate the file in the device's folders.

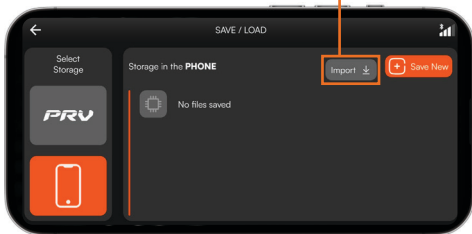

 This function is only available in the app and cannot be configured through the processor.

> AUDIO / FACTORY RESET

If necessary, you can restore all of the processor's original parameters by simultaneously holding the HOTKEY shortcuts for outputs 1, 2, and 3 while powering on the unit. If performed correctly, the processor's display will show a screen with two reset options:

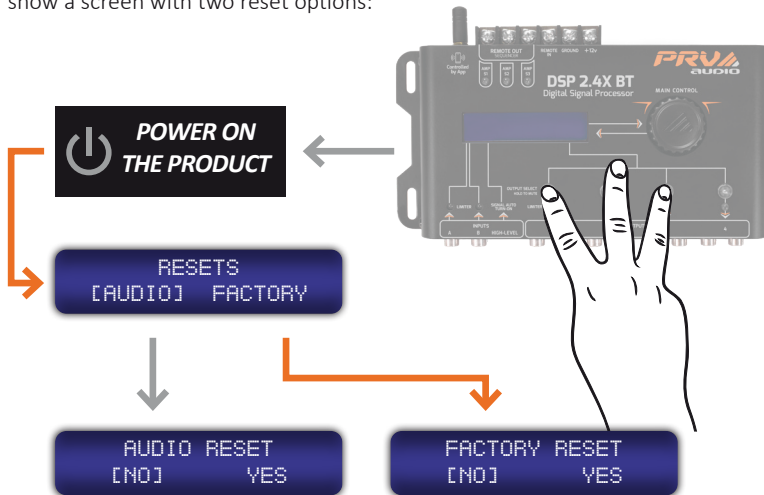

AUDIO: Restores only the audio settings, keeping passwords and other adjustments intact.

FACTORY: Restores all settings, including audio parameters, passwords, and general adjustments.

Use the encoder to select the desired option and confirm by pressing it.

In the app, this feature is available under **Settings > Restore Product**.

When selecting this option, two alternatives will be displayed (**Audio and Factory**), the same ones available when performing the reset directly on the processor:

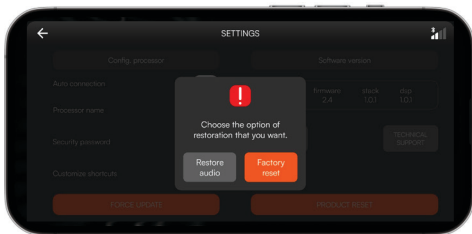

MAIN MENU ▶ COPY CHANNEL

Allows you to copy all audio settings from one output channel to another.

The copied parameters are: **OUTPUT PARAMETRIC EQUALIZER, ROUTING, CROSSOVER, ALIGNMENT, PHASE INVERSION, LIMITER, GAIN, and MUTE.**

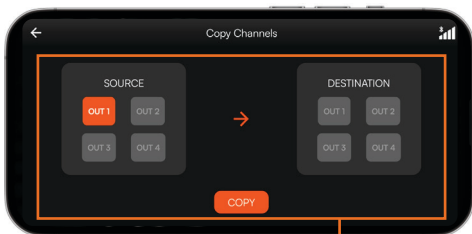

On the **COPY CHANNELS** screen, first select the **SOURCE** channel on the left side and then the **DESTINATION** channel on the right side. Next, tap **COPY** to transfer all settings from the source channel to the destination channel.

SETTINGS ▶ CHANNEL LINK

This function allows you to link pairs of output channels. When enabled, all audio settings made on the source channel will automatically be applied to the linked channel.

This feature is ideal for stereo setups or systems with duplicate speakers, as it simplifies the adjustment process and ensures consistent sound between channels, eliminating the need to configure each one separately.



Input parameters, signal routing, and channel mute are not affected by **CHANNEL LINK**. In other words, even when channels are linked, you can still keep inputs and signal paths independent.

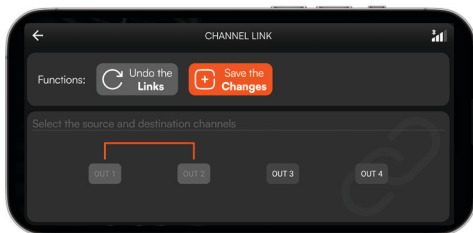
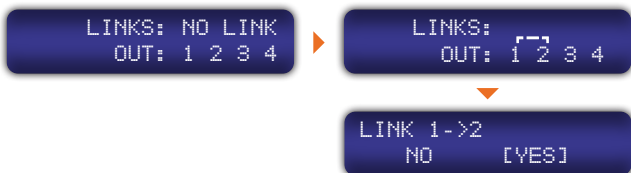

Set the source and destination channels (e.g., **CH1 > CH2**). The link will be indicated by an icon. Tap Save Changes to apply. To unlink, select Delete for the corresponding pair.

SETTINGS ▶ PASSWORD / SECURITY

Enable the processor lock to prevent local adjustments, saving, and loading of settings. The Lock/Unlock option is available in the menu.

DEFAULT PASSWORD:

1234

SECURITY
Lock/Un Lock

ENTER PASSWORD

To change the **PROCESSOR** password, use the **Change Password** option. Both passwords must be 4 digits (Numbers only).

SECURITY
Change Password

CHANGE PASSWORD
CurrentPW: ____

On the app's home screen, go to **Settings > Security Password** to make changes.

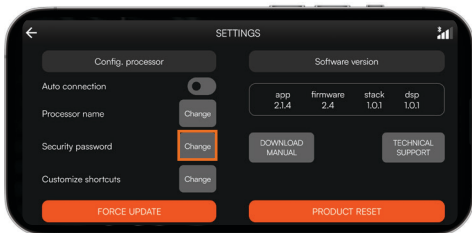

The password and lock are synchronized between the processor and the app. When the password is changed in one, it is automatically updated in the other.

With the lock enabled, the processor is completely restricted from any changes — its functions cannot be accessed or adjusted directly. However, if the app is connected with the correct password, settings can still be adjusted normally through it.

MAIN MENU ▶ AUDIO GENERATOR

The processor and the app provide two tools to assist in system tuning: the FREQUENCY GENERATOR and the FREQUENCY SWEEP.

Both act as internal signal sources, routed to all outputs. While using these functions, inputs A and B are automatically replaced by the generated signals, allowing normal application of adjustments and settings to each output.

> FREQUENCY

Allows you to generate a specific frequency with gain control.

Press the **MAIN BUTTON** to switch between the editable parameters: **FREQUENCY**, **GAIN**, and **ON/OFF**. With the generator activated, you can adjust the frequency and gain in real time, as well as modify other audio parameters of the processor.

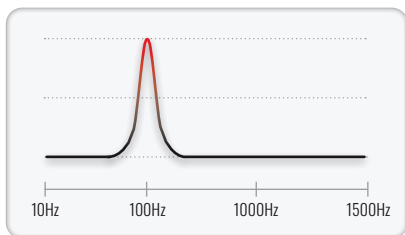

TONE GENERATOR
freq: 100 Hz

TONE GENERATOR
gain: -45.0 dB

TONE GENERATOR
OFF [ON]



> SWEEP

Allows you to perform a frequency sweep, with adjustments for start frequency, end frequency, gain, sweep speed, and **ON/OFF** activation.

When activated, the sweep runs in a continuous cycle. On the processor, you can stop the process by pressing a **HOTKEY** or turning the **MAIN BUTTON**.

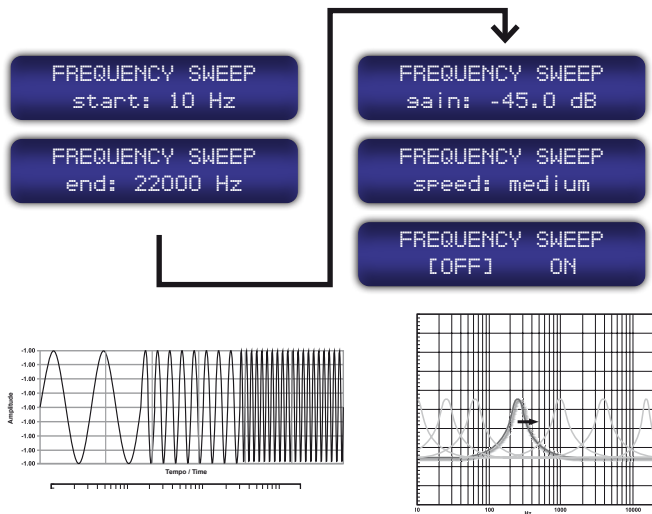

On the application screen, you can configure all sweep parameters: start and end frequency, gain, sweep speed, and **ON/OFF** activation.

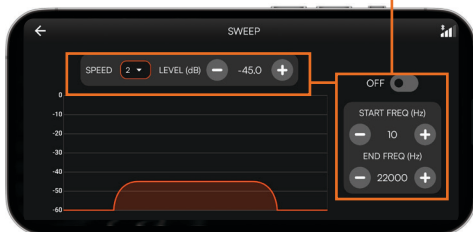

MAIN MENU ▶ SCREENSAVER

⚠ This function is available only on the processor and cannot be configured via the application.

The processor has a screensaver function, displayed when the product is powered on or when returning to the main menu. You can set a scrolling text of up to 15 characters.



SCREENSAVER
DSP 2.4X BT

MAIN MENU ▶ LANGUAGE

⚠ This function is available only on the processor and cannot be configured via the application.

On the processor, you can select the system display language from: **ENGLISH**, **PORTUGUESE**, and **SPANISH**.



LANGUAGE
<< ENGLISH >>

MAIN MENU ▶ SEQUENCER

Allows the remote activation of multiple products in sequence.

The processor has three outputs (**S1, S2, and S3**) that turn on or off in sequence as soon as a signal is received at the remote input (**REM IN**). The activation and deactivation times can be configured independently, with adjustable values from 0 to 4 seconds.

SEQUENCER
Time

Time ON : 0.5s
Time OFF: 2.0s



If the configured time is set to **0 seconds**, all outputs will turn on or off simultaneously.

Each sequencer output can be turned on or off independently. If an output is set to OFF, it will not be activated when the processor is powered on again until this setting is changed.

SEQUENCER
ON/OFF

SEQUENCER
S1: ON

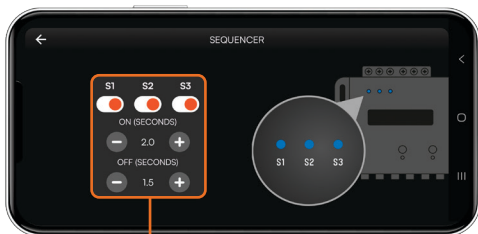

Set the amplifier activation time by defining the delay time for power-on and power-off.

Sequencer Installation Example

For remote output connections, use cables with a minimum cross-section of **18 AWG**

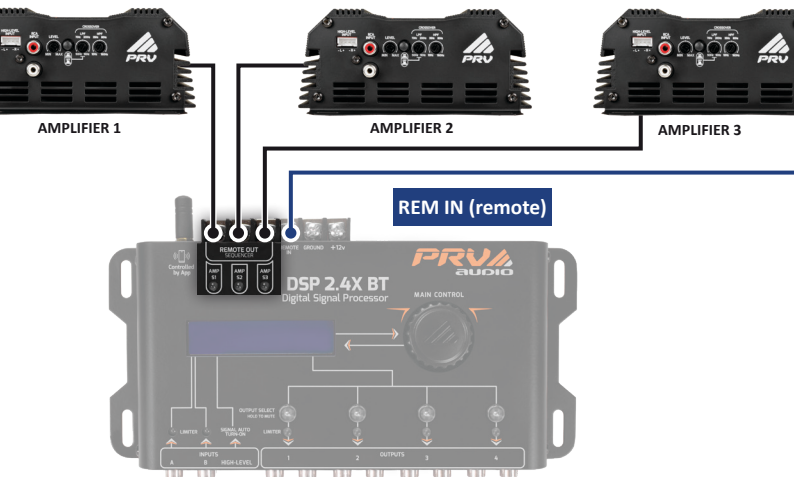

Troubleshooting

In cases of malfunction or abnormal product behavior, these tips can help with troubleshooting and problem-solving:

PRODUCT WILL NOT TURN ON

- Check if the cables are properly connected and if all connections have both electrical and mechanical contact.
- The fuses may be faulty or blown. Check their condition and make sure they match the specifications recommended for the equipment.
- Verify that the battery connections are energized and the charge is sufficient for the product to operate.

.....

NO SOUND

- The speaker cables or audio connections may be disconnected or defective. Check in the application if the desired audio source is selected for a better diagnosis.
- In the application, verify that the **LEVEL** control is not set to minimum or that the **MUTE** option is not active.



.....

AUDIO DISTORTION

- The speakers may be overloaded or defective. Check if the equalization settings are appropriate.

.....

WEAK BASS

- Speaker cables may have their polarities  and  reversed (speakers out of phase), or the phase inversion mode in the application may be active.

CONNECTION ISSUES WITH THE APPLICATION

- Make sure all permissions requested by the application are granted to allow pairing with the product.
- Check if the product is within range (up to 30 ft).
- Try restarting the product (turn it off for 10 seconds and turn it back on).
- Close the application and reopen it. Check for updates and, if necessary, reinstall the application (this last option will erase the application's internal settings).
- In case of a password connection failure, enter the new password or perform a factory reset on the processor.

If you have questions, contact the store where the purchase or installation was made.
For more information please contact: support@prvaudio.com



Any updates to this manual will be made available for consumer reference free of charge on the brand's website. It is recommended to consult the updated manual whenever necessary.

FCC Compliance Notice

FCC ID: 2BBF7-PRVDSP24XBT

This device complies with part 15 of the FCC Rules. Operation is subject to the following two conditions:

(1) This device may not cause harmful interference, and (2) this device must accept any interference received, including interference that may cause undesired operation.

Note: This equipment has been tested and found to comply with the limits for a Class B digital device, pursuant to part 15 of the FCC Rules. These limits are designed to provide reasonable protection against harmful interference in a residential installation. This equipment generates, uses and can radiate radio frequency energy and, if not installed and used in accordance with the instructions, may cause harmful interference to radio communications. However, there is no guarantee that interference will not occur in a particular installation.

If this equipment does cause harmful interference to radio or television reception, which can be determined by turning the equipment off and on, the user is encouraged to try to correct the interference by one or more of the following measures:

- Reorient or relocate the receiving antenna.
- Increase the separation between the equipment and receiver.
- Connect the equipment into an outlet on a circuit different from that to which the receiver is connected.
- Consult the dealer or an experienced radio/TV technician for help.

Note: The Grantee is not responsible for any changes or modifications not expressly approved by the party responsible for compliance. Such modifications could void the user's authority to operate the equipment.

The device has been evaluated to meet general RF exposure requirement. The device can be used in portable exposure condition without restriction.

Technical Specifications

Number of Channels:	Input: RCA (A+B) / HIGH INPUT (A+B) Output: RCA (1, 2, 3, 4)
Graphic Equalizer:	10 Bands (gain $\pm 12\text{dB}$)
Graphic EQ Presets:	12
Parametric Equalizer:	10 Bands (2 input + 8 output) (gain $\pm 12\text{dB}$, factor Q 0.4 ~ 10.0)
Crossover with Variable Frequency:	Butterworth: 12/18/24/30/36/42/48 dB/8^a Linkwitz-Riley: 12/18/24/30/36/42/48 dB/8^a Bessel: 12/18/24/30/36/42/48 dB/8^a
Routing:	A / B / A+B
Alignment:	0ms ~ 8ms (275cm)
Phase Inversion:	0° ~ 180°
Limiter:	Threshold: -48dB ~ 0dB Automatic Attack/Release Mode Attack: 0.1ms ~ 100.0ms Limiter ON/OFF Release: 1ms ~ 2000ms
Output Gain:	-45dB ~ +15dB
Frequency Generator:	10Hz ~ 22kHz (Level-60dB ~ 0dB)
Frequency Sweep:	10Hz ~ 22kHz (Level-60dB ~ 0dB)
Input Impedance:	RCA: 55 kΩ / HIGH INPUT: 1 kΩ
Output Impedance:	47 Ω
Total Harmonic Distortion (THD):	< 0,01% (THD)
Frequency Response:	10Hz ~ 22,5kHz @ -1dB
Power Supply Voltage:	9,0V ~ 16V DC
Max Sequencer Output Current:	180mA
Nominal Current Consumption:	180mA @ 12.6V DC
Maximum Current Consumption:	350mA @ 12.6V DC
Protection Circuit:	Curto-circuito (Fusível PTC) Shorting (PTC fuse)
Bluetooth:	Bluetooth 5.2 Low Energy
Dimensions (HxWxD):	1.41" x 4.60" x 8.79"
Weight:	1.1lb

Warranty Term

PRV Audio products are guaranteed for a period of ONE (1) YEAR from the date of original purchase against any manufacturer's defects in material and workmanship under normal use. This warranty protects only the original purchaser of PRV Audio products purchased from an Authorized PRV Audio Dealer. This warranty is non-transferable.

When a product is sent to PRV Audio for warranty claims, it is assumed that the original purchaser has read and fully understands the PRV Audio warranty policy. In no event shall PRV Audio be liable for incidental or consequential damages including, without limitation: injury to persons, property or loss of potential income.

Product must be repacked in original packaging or equivalent, with padding to avoid damages during transportation. The purchaser is responsible for expenses to return the product to PRV Audio Brazil for a Warranty Claim. Please DO NOT return your item to a retailer, all warranty claims must be sent to PRV Audio. Upon receipt of the item, PRV Audio will notify claimant within THREE (3) business days. At this time, PRV will let claimant know: (a) if the item qualifies for a warranty claim; (b) the expected turn-around time to receive the item back; (c) the proper procedure to follow to ensure minimal delays. If an item does not qualify for warranty, then claimant is responsible for ALL freight, shipping, and repair costs. The purchaser may decide if he/she wishes to repair the item for a fee. Please keep in mind all guidelines presented to you before sending your item! PRV Audio Brazil is NOT responsible for any return without an authorized number. If you have any questions concerning what voids a warranty, please do not hesitate to ask. We do this to protect our customers and our retailers. We want you to enjoy the best performance possible from PRV Audio products. Purchasing PRV Audio products from an authorized retailer means you are guaranteed.

RA Request Process

Access the website: www.prvaudio.com/warranty and fill up the form in order to receive a RA # (Return Authorization Number) prior to returning your item.

ATTENTION – Product is NOT eligible for warranty if serial number and/or warranty seal have been removed or tampered with.

This warranty does not extend to damage resulting from, but not limited to:

- Improper installation
- Product modification
- Misuse and neglect
- Abuse (items returned repeatedly for the same damage may be considered abuse)
- Damage resulting from attempted repairs by unauthorized repair centers or individuals
- Damage incurred during shipment
- Product damaged in an accident
- Damages due to criminal activity
- By 'acts of God' (lightning, flooding, etc.)
- Blown outputs or power supplies in amplifiers from overdriving or under voltage due to ignoring the LED Clipping Indicator
- Using an aluminum wire and/or any other wire that is not recommended in the owner's manual on a high-current amplifier
- We will not honor any warranty claim(s) on items purchased from internet sellers.
- Excessive vibration damage in items due to improper installation
- Installation and removal costs of the products associated with obtaining a warranty claim
- Products with the serial number and/or warranty seal removed or damaged

For any products not qualified for warranty protection, PRV can still repair it for a cost determined by the damages occurred to the unit. Thank you for choosing PRV!

We'll contact you as soon as possible once your Return Authorization (RA) request is processed. We will return your request with an RA number via e-mail. Thank you!



www.PRVAUDIO.com